

Truss Systems

W-W Trusses have been certified to support a live load of 35 lbs. per square foot. Trusses bolted to Stall Components which are attached to weld plates secured in the ground will resist a maximum uplift of 1700 lbs.-per-column post on 12' centers. When secured in this manner, stalls will resist a 90 mph wind load. Trusses are designed to fit 10' or 12' stalls. Trusses fit either "Classic" or "Champion" stall series.



Stalls with breezeway



Single Stall

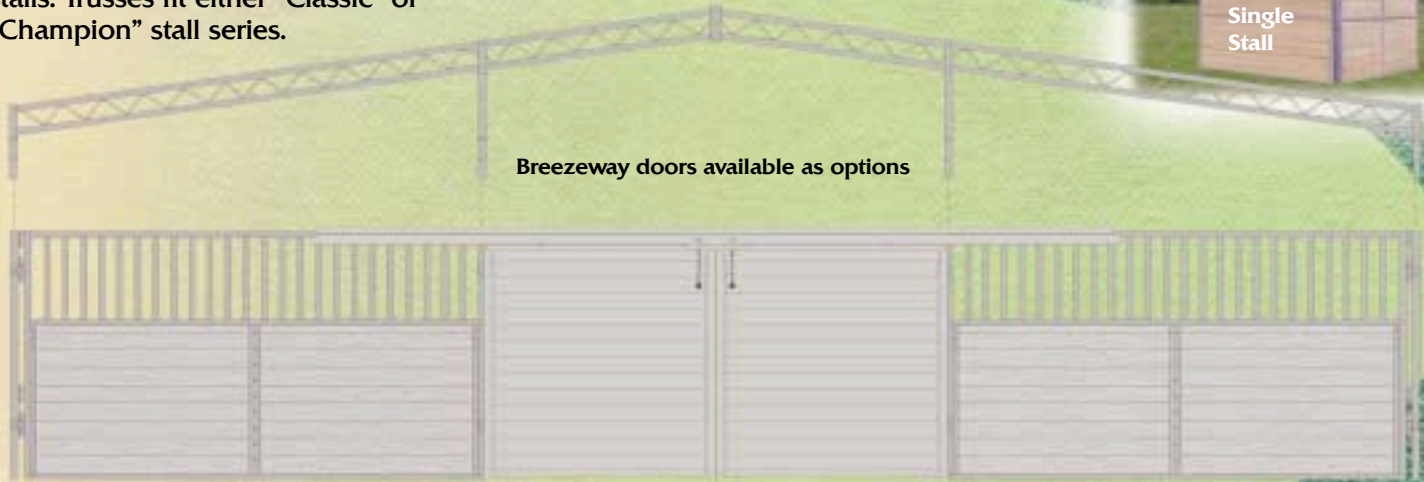

Breezeway doors available as options

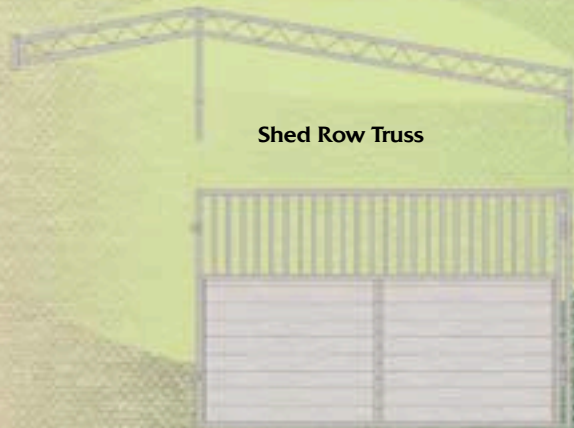

Shed Row Truss

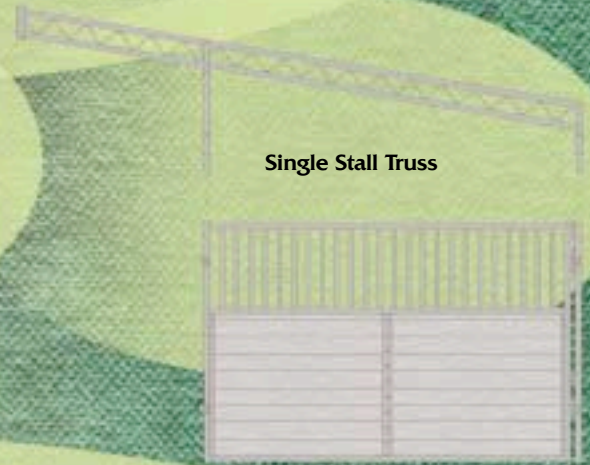

Single Stall Truss



Optional Girt Clips for attaching metal or wood to siding.



Truss System for back to back stalls



Trusses include brackets designed to receive 2" x 6" lumber